



**Toolholders with HSK-tapers shank DIN 69893-1**

**Collet chucks for collets DIN 6388 / ISO 10897**

Concentricity from the taper to the holding part < 0.005

Base-body balanced, G 2.5 - 20,000 r.p.m.

HSK-A100 - G2.5 - 15,000 r.p.m.

Special executions on inquiry

Delivery without collet

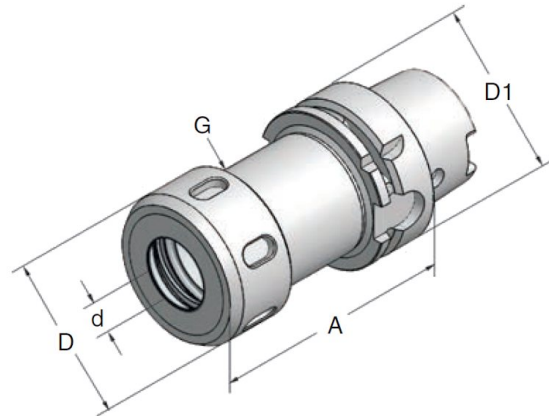

**HSK - A**

**HSK - A 50**

	<b>Art.-Nr.</b>	<b>Type</b>	<b>D1</b>	<b>A</b>	<b>d</b>	<b>D</b>	<b>G</b>
	50.11.16.1	HSK-A50x2-16x100	50	100	2-16	415E	43 M33x1.50
	<b>HSK - A 63</b>						
	63.11.16.1	HSK-A63x2-16x100	63	100	2-16	415E	43 M33x1.50
	63.11.25.1	HSK-A63x2-25x100	63	100	2-25	462E	60 M48x2.00
	<b>HSK - A 100</b>						
	100.11.32.1	HSK-A100x3-32x130	100	130	3-32	467E	72 M60x2.50

**HSK - F**

**HSK - F 50**

	<b>Art.-Nr.</b>	<b>Type</b>	<b>D1</b>	<b>A</b>	<b>d</b>	<b>D</b>	<b>G</b>
	50.13.25.1	HSK-F50x2-25x 76	50	76	2-25	426E	60 M48x2.00
	<b>HSK - F 63</b>						
	63.13.25.1	HSK-F63x2-25x 76	63	76	2-25	426E	60 M48x2.00
	63.13.25.12	HSK-F63x2-25x100	63	100	2-25	426E	60 M48x2.00

We reserve the right to make technical changes.