



## Sealing Discs

### Sealing discs for clamping nuts DIN 6499, DIN 6388 + ETS for tools with internal coolant supply

Coolant pressure min. 5 bar - max. 100 bar



The inserted O-ring seal ensures a coolant supply internally through the clamped tool directly to the cutting edge

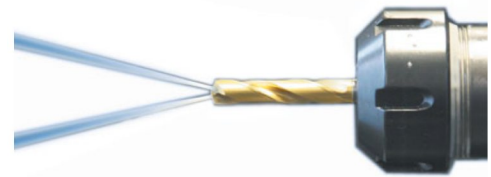
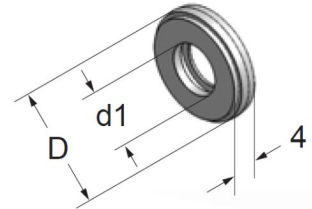
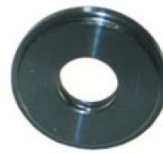

Art.-Nr.	Type	D	d1	Art.-Nr.	Type	D	d1	Sealing discs for clamping nuts <b>Ortlieb DIN 6388</b> for tools with internal coolant supply			
316040	DS/ER16	13	ø4 - 3	332040	DS/ER32	27	ø4 - 3				
316050	DS/ER16	13	ø5 - 4	332050	DS/ER32	27	ø5 - 4				
316060	DS/ER16	13	ø6 - 5	332060	DS/ER32	27	ø6 - 5				
316070	DS/ER16	13	ø7 - 6	332070	DS/ER32	27	ø7 - 6				
316080	DS/ER16	13	ø8 - 7	332080	DS/ER32	27	ø8 - 7				
316090	DS/ER16	13	ø9 - 8	332090	DS/ER32	27	ø9 - 8				
316100	DS/ER16	13	ø10 - 9	332100	DS/ER32	27	ø10 - 9	Art.-Nr.	Type	D	d1
				332110	DS/ER32	27	ø11 - 10	350050	DS/OZ25	31	ø5 - 4
320040	DS/ER20	16	ø4 - 3	332120	DS/ER32	27	ø12 - 11	350060	DS/OZ25	31	ø6 - 5
320050	DS/ER20	16	ø5 - 4	332130	DS/ER32	27	ø13 - 12	350070	DS/OZ25	31	ø7 - 6
320060	DS/ER20	16	ø6 - 5	332140	DS/ER32	27	ø14 - 13	350080	DS/OZ25	31	ø8 - 7
320070	DS/ER20	16	ø7 - 6	332150	DS/ER32	27	ø15 - 14	350090	DS/OZ25	31	ø9 - 8
320080	DS/ER20	16	ø8 - 7	332160	DS/ER32	27	ø16 - 15	350100	DS/OZ25	31	ø10 - 9
320090	DS/ER20	16	ø9 - 8	332170	DS/ER32	27	ø17 - 16	350110	DS/OZ25	31	ø11 - 10
320100	DS/ER20	16	ø10 - 9	332180	DS/ER32	27	ø18 - 17	350120	DS/OZ25	31	ø12 - 11
320110	DS/ER20	16	ø11 - 10	332190	DS/ER32	27	ø19 - 18	350130	DS/OZ25	31	ø13 - 12
320120	DS/ER20	16	ø12 - 11	332200	DS/ER32	27	ø20 - 19	350140	DS/OZ25	31	ø14 - 13
320130	DS/ER20	16	ø13 - 12					350150	DS/OZ25	31	ø15 - 14
				340050	DS/ER40	33.5	ø5 - 4	350160	DS/OZ25	31	ø16 - 15
325040	DS/ER25	21	ø4 - 3	340060	DS/ER40	33.5	ø6 - 5				

We reserve the right to make technical changes.

# Sealing Discs

## Sealing discs for clamping nuts DIN 6499, DIN 6388 + ETS for tools with internal coolant supply

Coolant pressure min. 5 bar - max. 100 bar

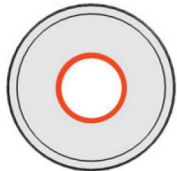

The inserted O-ring seal ensures a coolant supply internally through the clamped tool directly to the cutting edge

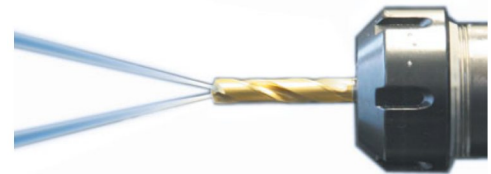
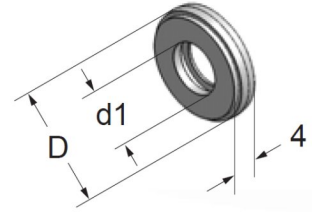

Art.-Nr.	Type	D	d1	Art.-Nr.	Type	D	d1	Art.-Nr.	Type	D	d1
325050	DS/ER25	21	ø5 - 4	340070	DS/ER40	33.5	ø7 - 6	350170	DS/OZ25	31	ø17 - 16
325060	DS/ER25	21	ø6 - 5	340080	DS/ER40	33.5	ø8 - 7	350180	DS/OZ25	31	ø18 - 17
325070	DS/ER25	21	ø7 - 6	340090	DS/ER40	33.5	ø9 - 8	350190	DS/OZ25	31	ø19 - 18
325080	DS/ER25	21	ø8 - 7	340100	DS/ER40	33.5	ø10 - 9	350200	DS/OZ25	31	ø20 - 19
325090	DS/ER25	21	ø9 - 8	340110	DS/ER40	33.5	ø11 - 10	350210	DS/OZ25	31	ø21 - 20
325100	DS/ER25	21	ø10 - 9	340120	DS/ER40	33.5	ø12 - 11	350220	DS/OZ25	31	ø22 - 21
325110	DS/ER25	21	ø11 - 10	340130	DS/ER40	33.5	ø13 - 12	350230	DS/OZ25	31	ø23 - 22
325120	DS/ER25	21	ø12 - 11	340140	DS/ER40	33.5	ø14 - 13	350240	DS/OZ25	31	ø24 - 23
325130	DS/ER25	21	ø13 - 12	340150	DS/ER40	33.5	ø15 - 14	350250	DS/OZ25	31	ø25 - 24
325140	DS/ER25	21	ø14 - 13	340160	DS/ER40	33.5	ø16 - 15				
325150	DS/ER25	21	ø15 - 14	340170	DS/ER40	33.5	ø17 - 16				
325160	DS/ER25	21	ø16 - 15	340180	DS/ER40	33.5	ø18 - 17				
				340190	DS/ER40	33.5	ø19 - 18				
				340200	DS/ER40	33.5	ø20 - 19				
				340210	DS/ER40	33.5	ø21 - 20				
				340220	DS/ER40	33.5	ø22 - 21				
				340230	DS/ER40	33.5	ø23 - 22				
				340240	DS/ER40	33.5	ø24 - 23				
				340250	DS/ER40	33.5	ø25 - 24				
				340260	DS/ER40	33.5	ø26 - 25				

We reserve the right to make technical changes.