

## ISO Taper-toolholders **BT-P**

### Collet chucks for collets ER/ESX DIN 6499 / ISO 15488

Concentricity from the taper to the holding part < 0.005

**BT-P30** G 2.5 - 25,000 U/min. or U < 1 gmm

**BT-P40** G 2.5 - 20,000 U/min. or U < 1 gmm

Delivery without tool and collet

ER11-ER32 Tools without coolant supply



**MAS BT-P with flange contact**



Clamping nut - delivery

**BT-P30**

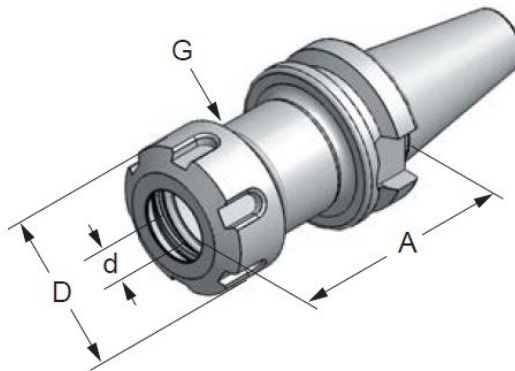

**BT-P40**

| Art.-Nr.    | Type               | A   | d     | D  | G        | Art.-Nr.    | Type               | A   | d    | D  | G        |
|-------------|--------------------|-----|-------|----|----------|-------------|--------------------|-----|------|----|----------|
| 30.06.07.2  | BT-P30xER11x 70-AD | 70  | 1 - 7 | 19 | M14x0.75 |             |                    |     |      |    |          |
| 30.06.10.20 | BT-P30xER16x 50-AD | 50  | 1-10  | 28 | M22x1.50 |             |                    |     |      |    |          |
| 30.06.10.2  | BT-P30xER16x 70-AD | 70  | 1-10  | 28 | M22x1.50 | 40.06.10.2  | BT-P40xER16x 70-AD | 70  | 1-10 | 28 | M22x1.50 |
| 30.06.16.2  | BT-P30xER25x 70-AD | 70  | 1-16  | 42 | M32x1.50 | 40.06.16.2  | BT-P40xER25x 70-AD | 70  | 1-16 | 42 | M32x1.50 |
| 30.06.16.20 | BT-P30xER25x 50-AD | 50  | 1-16  | 42 | M32x1.50 |             |                    |     |      |    |          |
| 30.06.20.2  | BT-P30xER32x 70-AD | 70  | 2-20  | 50 | M40x1.50 | 40.06.20.2  | BT-P40xER32x 70-AD | 70  | 2-20 | 50 | M40x1.50 |
| 30.06.20.20 | BT-P30xER32x 50-AD | 50  | 2-20  | 50 | M40x1.50 |             |                    |     |      |    |          |
|             |                    |     |       |    |          |             |                    |     |      |    |          |
| 30.06.07.22 | BT-P30xER11x100-AD | 100 | 1 - 7 | 19 | M14x0.75 |             |                    |     |      |    |          |
| 30.06.10.22 | BT-P30xER16x100-AD | 100 | 1-10  | 28 | M22x1.50 | 40.06.10.22 | BT-P40xER16x100-AD | 100 | 1-10 | 28 | M22x1.50 |
| 30.06.16.22 | BT-P30xER25x100-AD | 100 | 1-16  | 42 | M32x1.50 | 40.06.16.22 | BT-P40xER25x100-AD | 100 | 1-16 | 42 | M32x1.50 |
| 30.06.20.22 | BT-P30xER32x100-AD | 100 | 2-20  | 50 | M40x1.50 | 40.06.20.22 | BT-P40xER32x100-AD | 100 | 2-20 | 50 | M40x1.50 |

We reserve the right to make technical changes.

# ISO Taper-toolholders **BT-P**

For cutting tools **with internal coolant** you need GMGC clamping nuts and DS-sealing discs



**Clamping nut friction bearing DIN 6499 for sealing disc**

**Sealing discs for tools with internal coolant supply**

The inserted O-ring seal ensures a coolant supply internally through the clamped tool directly to the cutting edge

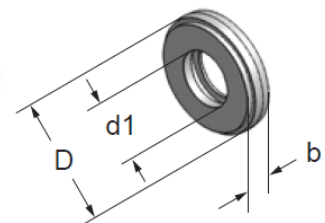
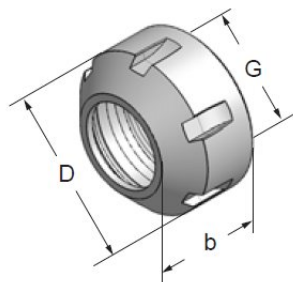

| Art.-Nr.                                   | Type      | D  | b  | G        | Nm max. | Art.-Nr. | Type    | D    | b | d1              |
|--|-----------|----|----|----------|---------|----------|---------|------|---|-----------------|
| 716124                                     | GMGC/ER16 | 28 | 23 | M22x1.50 | 70      | 316...   | DS/ER16 | 13.0 | 4 | 316050 - 316100 |
| 720124                                     | GMGC/ER20 | 34 | 25 | M25x1.50 | 100     | 320...   | DS/ER20 | 16.0 | 4 | 320050 - 320130 |
| 725124                                     | GMGC/ER25 | 42 | 26 | M32x1.50 | 130     | 325...   | DS/ER25 | 21.0 | 4 | 325050 - 325160 |
| 732124                                     | GMGC/ER32 | 50 | 28 | M40x1.50 | 170     | 332...   | DS/ER32 | 27.0 | 4 | 332050 - 332200 |
| Coolant pressure min. 5 bar - max. 100 bar |           |    |    |          |         |          |         |      |   |                 |

We reserve the right to make technical changes.