

Sealing Discs

Sealing discs for clamping nuts DIN 6499, DIN 6388 + ETS for tools with internal coolant supply

Coolant pressure min. 5 bar - max. 100 bar

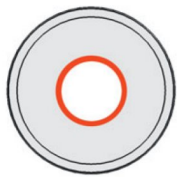

The inserted O-ring seal ensures a coolant supply internally through the clamped tool directly to the cutting edge

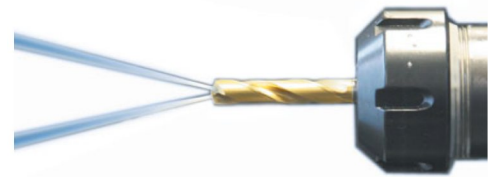
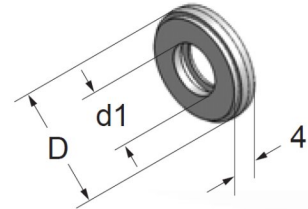

Art.-Nr.	Type	D	d1	Art.-Nr.	Type	D	d1	Sealing discs for clamping nuts Ortlieb DIN 6388 for tools with internal coolant supply
316040	DS/ER16	13	ø4 - 3	332040	DS/ER32	27	ø4 - 3	
316050	DS/ER16	13	ø5 - 4	332050	DS/ER32	27	ø5 - 4	
316060	DS/ER16	13	ø6 - 5	332060	DS/ER32	27	ø6 - 5	
316070	DS/ER16	13	ø7 - 6	332070	DS/ER32	27	ø7 - 6	
316080	DS/ER16	13	ø8 - 7	332080	DS/ER32	27	ø8 - 7	
316090	DS/ER16	13	ø9 - 8	332090	DS/ER32	27	ø9 - 8	
316100	DS/ER16	13	ø10 - 9	332100	DS/ER32	27	ø10 - 9	
				332110	DS/ER32	27	ø11 - 10	Art.-Nr.
320040	DS/ER20	16	ø4 - 3	332120	DS/ER32	27	ø12 - 11	Type
320050	DS/ER20	16	ø5 - 4	332130	DS/ER32	27	ø13 - 12	D
320060	DS/ER20	16	ø6 - 5	332140	DS/ER32	27	ø14 - 13	d1
320070	DS/ER20	16	ø7 - 6	332150	DS/ER32	27	ø15 - 14	350050
320080	DS/ER20	16	ø8 - 7	332160	DS/ER32	27	ø16 - 15	DS/OZ25
320090	DS/ER20	16	ø9 - 8	332170	DS/ER32	27	ø17 - 16	31
320100	DS/ER20	16	ø10 - 9	332180	DS/ER32	27	ø18 - 17	ø5 - 4
320110	DS/ER20	16	ø11 - 10	332190	DS/ER32	27	ø19 - 18	350060
320120	DS/ER20	16	ø12 - 11	332200	DS/ER32	27	ø20 - 19	DS/OZ25
320130	DS/ER20	16	ø13 - 12					31
				340050	DS/ER40	33.5	ø5 - 4	ø7 - 6
325040	DS/ER25	21	ø4 - 3	340060	DS/ER40	33.5	ø6 - 5	350070
								DS/OZ25
								31
								ø8 - 7
								350080
								DS/OZ25
								31
								ø9 - 8
								350090
								DS/OZ25
								31
								ø10 - 9
								350100
								DS/OZ25
								31
								ø11 - 10
								350110
								DS/OZ25
								31
								ø12 - 11
								350120
								DS/OZ25
								31
								ø13 - 12
								350130
								DS/OZ25
								31
								ø14 - 13
								350140
								DS/OZ25
								31
								ø15 - 14
								350150
								DS/OZ25
								31
								ø16 - 15
								350160
								DS/OZ25
								31

We reserve the right to make technical changes.

Sealing Discs

Sealing discs for clamping nuts DIN 6499, DIN 6388 + ETS for tools with internal coolant supply

Coolant pressure min. 5 bar - max. 100 bar

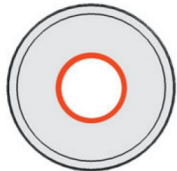

The inserted O-ring seal ensures a coolant supply internally through the clamped tool directly to the cutting edge

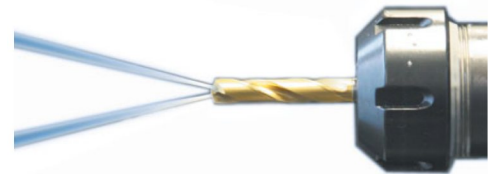
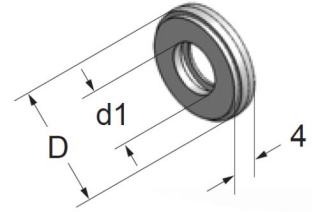
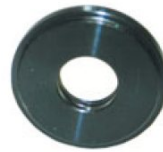

Art.-Nr.	Type	D	d1	Art.-Nr.	Type	D	d1	Art.-Nr.	Type	D	d1
325050	DS/ER25	21	ø5 - 4	340070	DS/ER40	33.5	ø7 - 6	350170	DS/OZ25	31	ø17 - 16
325060	DS/ER25	21	ø6 - 5	340080	DS/ER40	33.5	ø8 - 7	350180	DS/OZ25	31	ø18 - 17
325070	DS/ER25	21	ø7 - 6	340090	DS/ER40	33.5	ø9 - 8	350190	DS/OZ25	31	ø19 - 18
325080	DS/ER25	21	ø8 - 7	340100	DS/ER40	33.5	ø10 - 9	350200	DS/OZ25	31	ø20 - 19
325090	DS/ER25	21	ø9 - 8	340110	DS/ER40	33.5	ø11 - 10	350210	DS/OZ25	31	ø21 - 20
325100	DS/ER25	21	ø10 - 9	340120	DS/ER40	33.5	ø12 - 11	350220	DS/OZ25	31	ø22 - 21
325110	DS/ER25	21	ø11 - 10	340130	DS/ER40	33.5	ø13 - 12	350230	DS/OZ25	31	ø23 - 22
325120	DS/ER25	21	ø12 - 11	340140	DS/ER40	33.5	ø14 - 13	350240	DS/OZ25	31	ø24 - 23
325130	DS/ER25	21	ø13 - 12	340150	DS/ER40	33.5	ø15 - 14	350250	DS/OZ25	31	ø25 - 24
325140	DS/ER25	21	ø14 - 13	340160	DS/ER40	33.5	ø16 - 15				
325150	DS/ER25	21	ø15 - 14	340170	DS/ER40	33.5	ø17 - 16				
325160	DS/ER25	21	ø16 - 15	340180	DS/ER40	33.5	ø18 - 17				
				340190	DS/ER40	33.5	ø19 - 18				
				340200	DS/ER40	33.5	ø20 - 19				
				340210	DS/ER40	33.5	ø21 - 20				
				340220	DS/ER40	33.5	ø22 - 21				
				340230	DS/ER40	33.5	ø23 - 22				
				340240	DS/ER40	33.5	ø24 - 23				
				340250	DS/ER40	33.5	ø25 - 24				
				340260	DS/ER40	33.5	ø26 - 25				

We reserve the right to make technical changes.