

Driven tools DIN 69880 / DIN ISO 10889

Radial drilling and milling head

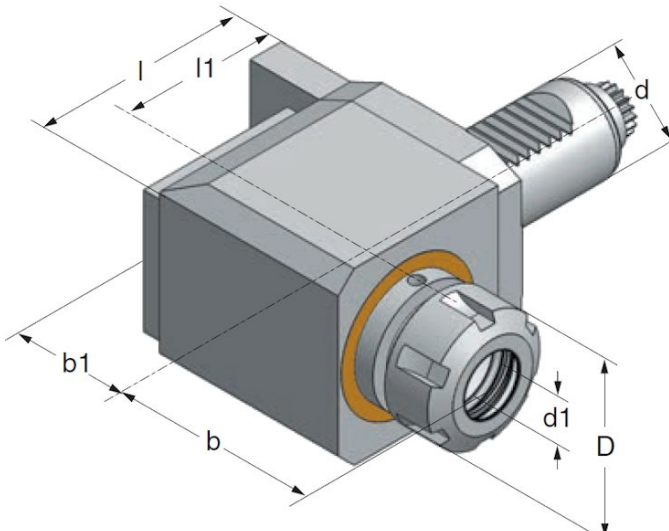

Picture shows Type R



Sauter-Revolver DIN 5480 **CTX**



Sauter-Revolver DIN 5482 **5482**



Diplomatic DIN 1809 **1809**



Barrufaldi TOEM **TOEM**



Art.-Nr.	Type	d	d1	l	l1	b	b1
6.2016CTX R	VDI20xER16	20	1-10	68	45	57	32
6.2016CTX L	VDI20xER16	20	1-10	68	45	57	32
6.2016LCTX R	VDI20xER16	20	1-10	101	75	62	48
6.2016LCTX L	VDI20xER16	20	1-10	101	75	62	48
6.2020CTX R	VDI20xER20	20	1-13	68	45	57	32
6.2020CTX L	VDI20xER20	20	1-13	68	45	57	32
6.20161809 R	VDI20xER16	20	1-10	68	48	58	25
6.20161809 L	VDI20xER16	20	1-10	68	48	58	25
6.2525CTXL R	VDI25xER25	25	1-16	101	75	63	40
6.2525CTXL L	VDI25xER25	25	1-16	101	75	63	40
6.3025CTX R	VDI30xER25	30	1-16	81	55	63	48
6.3025CTX L	VDI30xER25	30	1-16	81	55	63	48
6.3025CTX Rk	VDI30xER25	30	1-16	81	55	63	48
6.3025CTX Lk	VDI30xER25	30	1-16	81	55	63	48
6.3025LCTX RL	VDI30xER25	30	1-16	126	100	63	48
6.3025LCTX RLk	VDI30xER25	30	1-16	126	100	63	48
6.30255482 R	VDI30xER25	30	1-16	81	55	63	48
6.30255482 L	VDI30xER25	30	1-16	81	55	63	48
6.30255482 Rk	VDI30xER25	30	1-16	81	55	63	48
6.30255482 Lk	VDI30xER25	30	1-16	81	55	63	48
6.30251809 R	VDI30xER25	30	1-16	81	55	63	48
6.30251809 L	VDI30xER25	30	1-16	81	55	63	48
6.30251809 Rk	VDI30xER25	30	1-16	81	55	63	48
6.30251809 Lk	VDI30xER25	30	1-16	81	55	63	48
6.3025LT10 R	VDI30xER25	30	1-16	81	55	63	48
6.3025LT10 L	VDI30xER25	30	1-16	81	55	63	48
6.3025LT10 Rk	VDI30xER25	30	1-16	81	55	63	48
6.3025LT10 Lk	VDI30xER25	30	1-16	81	55	63	48

Type R right hand design as shown

Type L left hand design reversed

Type RL with doubletoothed VDI-shaft

Type k with internal cooling supply

In case of inquiry please indicate details of type of machine as shown

We reserve the right to make technical changes.

Radial drilling and milling head



Picture shows Type R

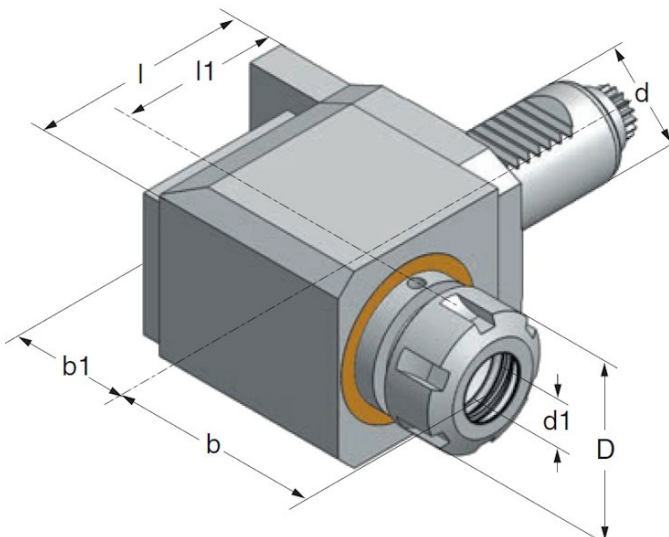

Sauter-Revolver DIN 5480 **CTX**



Sauter-Revolver DIN 5482 **5482**



Diplomatic DIN 1809 **1809**



Barrufaldi TOEM **TOEM**



In case of inquiry please indicate details of **type** of machine as shown

Art.-Nr.	Type	d	d1	l	l1	b	b1
6.4032CTX R	VDI40xER32	40	2-20	103	65	82	72
6.4032CTX L	VDI40xER32	40	2-20	103	65	82	72
6.4032CTX Rk	VDI40xER32	40	2-20	103	65	82	72
6.4032CTX Lk	VDI40xER32	40	2-20	103	65	82	72
6.4032CTX RL	VDI40xER32	40	2-20	138	100	85	53
6.4032CTX RLk	VDI40xER32	40	2-20	138	100	85	53
6.4032LCTX RL	VDI40xER32	40	2-20	158	120	85	53
6.4032LCTX RLk	VDI40xER32	40	2-20	158	120	85	53
6.40325482 R	VDI40xER32	40	2-20	103	65	82	72
6.40325482 L	VDI40xER32	40	2-20	103	65	82	72
6.40325482 Rk	VDI40xER32	40	2-20	103	65	82	72
6.40325482 Lk	VDI40xER32	40	2-20	103	65	82	72
6.40321809 R	VDI40xER32	40	2-20	103	65	82	72
6.40321809 L	VDI40xER32	40	2-20	103	65	82	72
6.40321809 Rk	VDI40xER32	40	2-20	103	65	82	72
6.40321809 Lk	VDI40xER32	40	2-20	103	65	82	72
6.4032TOEM R	VDI40xER32	40	2-20	103	65	82	72
6.4032TOEM L	VDI40xER32	40	2-20	103	65	82	72
6.4032LT15 RL	VDI40xER32	40	2-20	103	65	82	72
6.4032LT15 RLk	VDI40xER32	40	2-20	103	65	82	72
6.4032TMM250	VDI40xER32	40	2-20	128	90	82	72
6.50405480 R	VDI50xER40	50	3-30	119	75	96	84
6.50405480 L	VDI50xER40	50	3-30	119	75	96	84
6.50401809 R	VDI50xER40	50	3-30	119	75	96	84
6.50401809 L	VDI50xER40	50	3-30	119	75	96	84
6.50401809 Rk	VDI50xER40	50	3-30	119	75	96	84
6.50401809 Lk	VDI50xER40	50	3-30	119	75	96	84

Type R right hand design as shown

Type L left hand design reversed

Type RL with doubletoothed VDI-shaft

Type k with internal cooling supply

We reserve the right to make technical changes.