



**Toolholders for CNC machines DIN 69880 / DIN ISO 10889**

**Bar puller clamping range  $\varnothing 10 - 75\text{mm}$**

Incl. 2 sets clamping jaws ( $\varnothing 10-50$  &  $\varnothing 45-75$ )

Art.-Nr.	
30.0924	<b>excl. shank</b>

*The shank has to be ordered separately !*

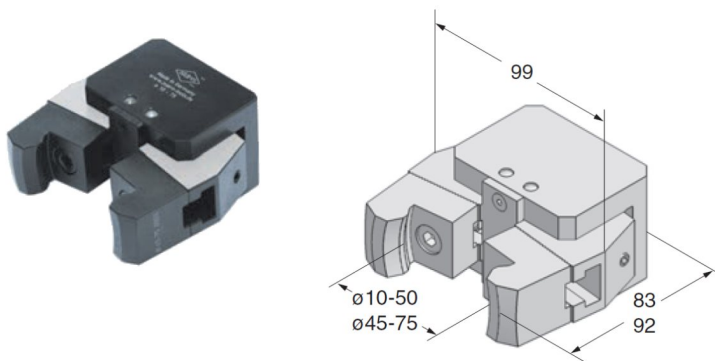

**Shaft for bar puller**

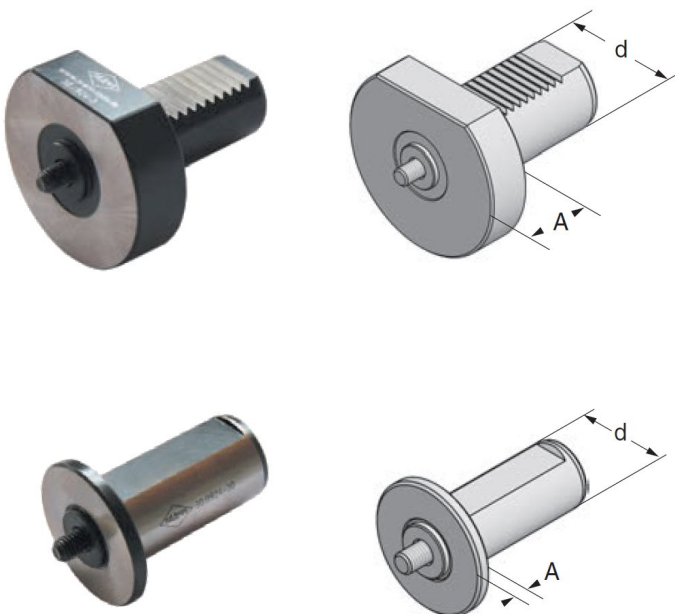

Art.-Nr.	d	A
30.0924-2	VDI 20	15
30.0924-3	VDI 30	20
30.0924-4	VDI 40	20
30.0924-5	VDI 50	20
<b>Cylinder Shaft</b>		
30.0924-25	zyl.25	5
30.0924-30	zyl.30	5
30.0924-32	zyl.32	5
30.0924-40	zyl.40	5
30.0924-50	zyl.50	0
<b>INCH</b>		
30.0924-38.1	zyl.1 1/2"	5

We reserve the right to make technical changes.

Rotary stop adjustable length,  
spring mounted

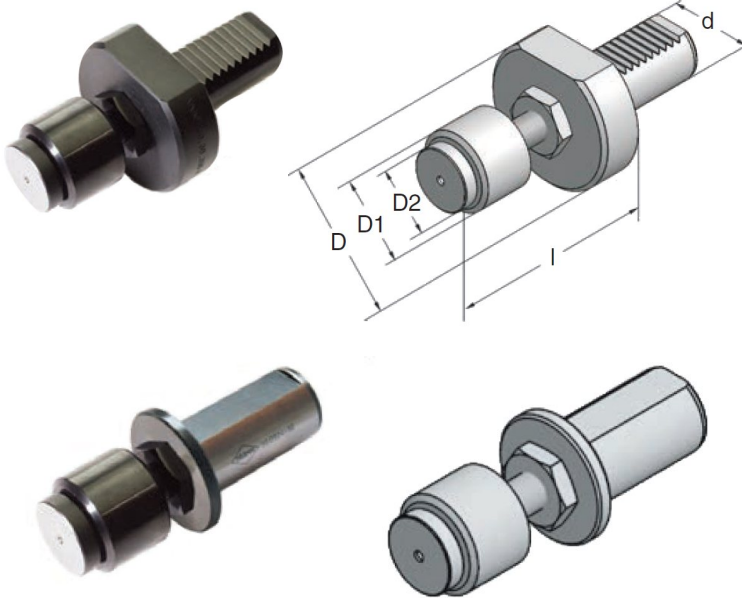

Art.-Nr.	Type	d	D	D1	D2	l
25.30.355	VDI 25	25	58	38	25	65-100
30.38.355	VDI 30	30	68	38	25	65-100
40.60.355	VDI 40	40	83	60	40	80-150
50.60.355	VDI 50	50	98	60	40	80-150

Cylinder Shaft

Art.-Nr.	Type	d	D	D1	D2	l
32.38.355	zyl.32	32	44	38	25	50- 85

Rotary stop spring mounted

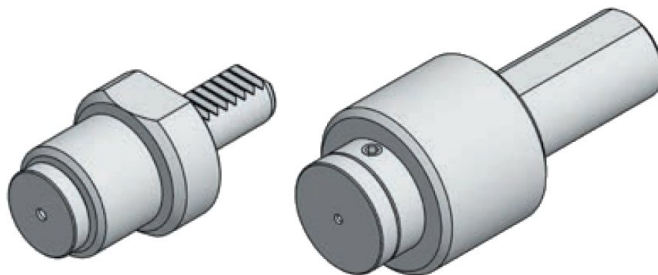

Art.-Nr.	Type	d	D	D1	D2	l
20.30.355	VDI 20	20	50	38	25	55

Cylinder Shaft

Art.-Nr.	Type	d	D	D1	D2	l
32.60.355	zyl.32	32	-	60	40	69

We reserve the right to make technical changes.